



TENSIONING FORM FINISHER MOD 2060



Automatic tensioning form finisher for ironing men's or women's jackets and overcoats, or wool garments, extremely compact in size.

Features and strength

Time switch programmed through digital electronic control panel.
Steaming brush/iron.
Pivoting control board.
10 different work programs to perform all kind of garments and size.
Automatic or manual operation.
Vertical and horizontal garment tensioning for perfect finishing
Adjustable shoulders.
Automatic size adjustment.
Strong ventilation unit with air-regulation.

Main options

All steam irons



Made in Italy with Italian Fashion Mind



TECHNICAL FEATURES 2060

| Electric Connections | | Mod 2060 |
|-------------------------------------|------|--------------------|
| Standard voltage | | |
| 400V-3Ph-50Hz | kW | 3 |
| other voltages available on request | | |
| Vacuum motor power | kW | 1,1 |
| Super heating device | kW | 1 |
| Steam and air connection | | |
| Steam inlet | inch | 1/2 " |
| Steam outlet | inch | 1/2 " |
| Steam supply | Kpa | 400 - 600 |
| Steam supply | bar | 6 |
| Steam consumption | kg/h | 15-20 |
| Compressed Air inlet | inch | 1/4 " |
| Compressed Air supply | Kpa | 600-800 |
| Compressed Air supply | bar | 6 |
| Shipping details | | |
| Packing type | | Pallet+carton box |
| Packing size | mm | 1000 x 900 x 1600H |
| Net weight | kg | 180 |
| Gross weight | kg | 200 |

TOP VIEW

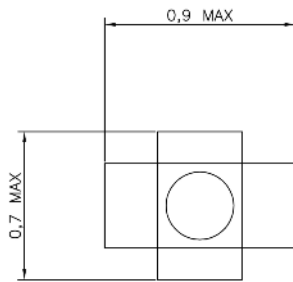

REAR VIEW

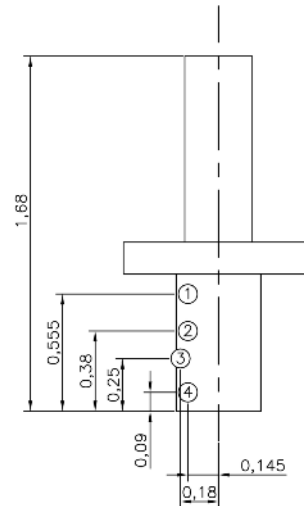

| | | |
|---|---------------------|--------|
| ④ | ELECTRIC POWER | --- |
| ③ | AIR INLET | # 8mm |
| ② | CONDENSATION RETURN | 1/2" F |
| ① | STEAM | 1/2" F |



ROTONDI group Srl
 Via Fratelli Rosselli, 14/16
 20019 Settimo Milanese (Milano) - Italia
 Tel. (+39) 02.335.01.224 - Fax (+39) 02.335.01.329
 E-mail: rotondi@rotondigroup.it
www.rotondigroup.com

Agente: